



1209 DISTRIBUTORS ROW ■ NEW ORLEANS, LA 70123 U.S.A.
 TELEPHONE: (504)340-0055 ■ FAX: (504)340-0056

GENERAL DESCRIPTION:

The Ruelco Status Indicator is designed to give positive indication of a pneumatic control signal. When pneumatic pressure is applied to the Status Indicator, the viewable window will indicate green. When the pneumatic signal is removed, the indicator will show red. Its simple and compact design makes maintenance and repair easy. The Status Indicator does not have to be removed from the control panel or system loop if repair or maintenance is necessary.

STATUS INDICATOR

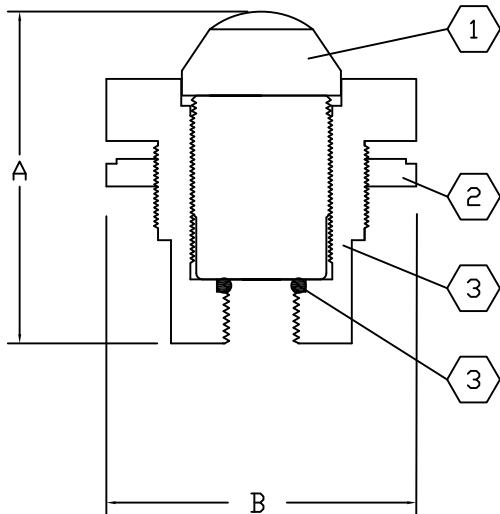

ITEM	QTY.	DESCRIPTION	MATERIAL	PART No.
1	1	INDICATOR	PLASTIC	MD-GR-HP
2	1	PANEL NUT	316 S.S.	10-006-000
3	1	KNOB	316 S.S.	64-001-000
4*	-	BASE SEAL	VITON	VO-108-090
5	-	REPAIR KIT	* ITEMS	64-002-000

SPECIFICATIONS

INLET CONNECTION	1/8" NPT
MAX. OPER. PRESSURE	100 PSI (6.90 BAR)
AMBIENT TEMPERATURE RANGE	-20 TO 250° F -29 TO 122° C

DIMENSIONS IN (mm)

A	1.70 (43.18)
B	1.50 (38.1)

MODEL 6400

ORDERING CODE: 6400 - 10000

WHILE THIS INFORMATION IS PRESENTED IN GOOD FAITH AND BELIEVED TO BE ACCURATE, RUELCO, INC. DOES NOT GUARANTEE SATISFACTORY RESULTS FROM RELIANCE ON SUCH INFORMATION. NOTHING CONTAINED HEREIN IS TO BE CONSTRUED AS A WARRANTY OR GUARANTEE, EXPRESSED OR IMPLIED, REGARDING THE PERFORMANCE, MERCHANTABILITY, AND FITNESS WITH RESPECT TO THE PRODUCT. RUELCO, INC. RESERVES THE RIGHT, WITHOUT NOTICE, TO ALTER OR IMPROVE THE DESIGNS OR SPECIFICATIONS OF THE PRODUCTS DESCRIBED HEREIN.