

Ruelco

1209 DISTRIBUTORS ROW ■ NEW ORLEANS, LA 70123 U.S.A.
TELEPHONE: (504)340-0055 ■ FAX: (504)340-0056

GENERAL DESCRIPTION:

The Ruelco RD-1 is a 2-way normally open hydraulic controller that acts as a snap acting vent valve on loss of pilot pressure. This configuration of the Ruelco "RD-1" permits control of hydraulic pressure up to 10,000 psi. A pilot supply of 100 psi is necessary to control 10,000 psi of hydraulic pressure. Minimum recommended pilot pressure is 30 psi. A high ratio of hydraulic pressure to pilot control pressure ensures safe operation. A soft seal design ensures zero leakage in the hydraulic section.

The internal spring and the hydraulic pressure acting on the spool area are jointly responsible for opening the valve, although each on its own provides sufficient force to open the valve.

Ruggedly constructed stainless steel process wetted parts provide years of reliable service and the compact and simple makes field maintenance easy.

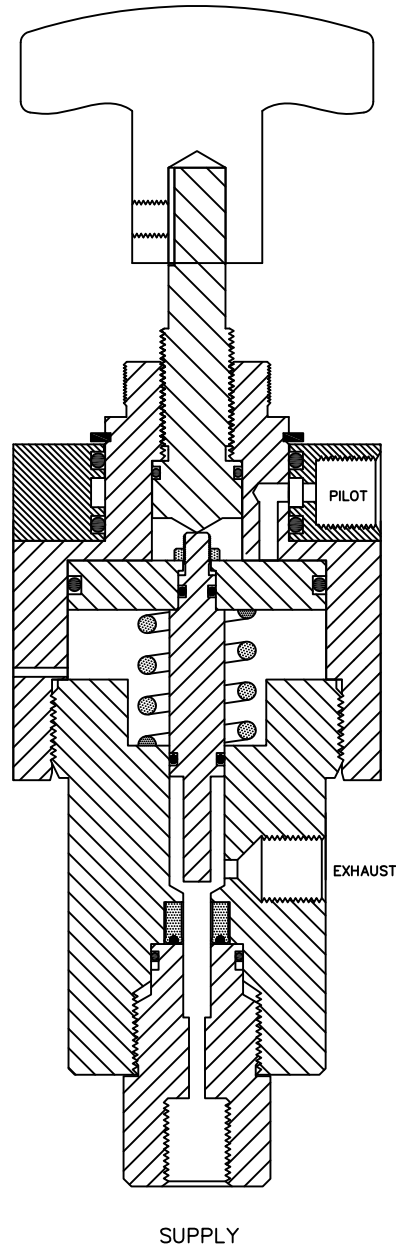

RD-1

2 WAY DUMP VALVE

MODEL 8001

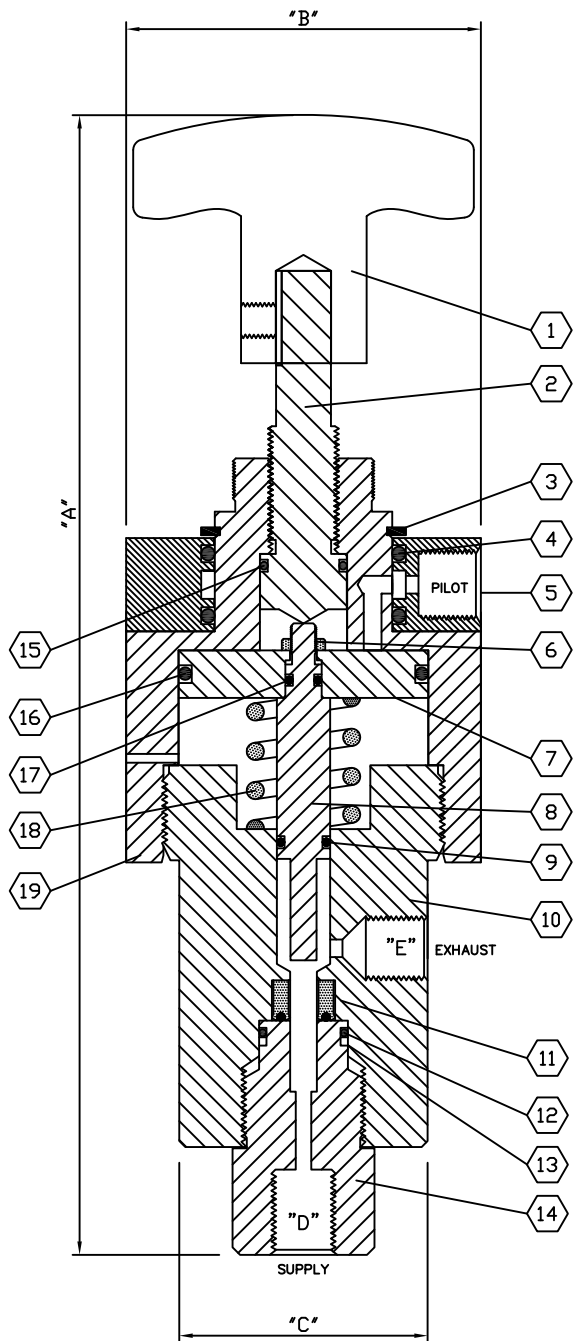

PARTS LIST FOR RD-1 DUMP VALVE

ITEM	QTY.	DESCRIPTION	MATERIAL	PART No.
1	1	Knob	Delrin	81-012-000
2	1	Override	316 St. Stl.	80-012-000
3	1	Snap Ring	Viton	SH-150-050
4*	2	O-Ring	Viton	V0-124-70H
5	1	Air Ring	316 St. Stl.	81-011-000
6	1	Lock Nut	316 St. Stl.	T6-832-044
7	1	Piston	316 St. Stl.	80-003-000
8	1	Spool	316 St. Stl.	80-002-000
9*	1	O-Ring	Viton	V0-009-70T
10	1	Body	316 St. Stl.	80-001-000
11*	1	Polypak	Fluoromyte	FU-187-70H
12*	1	O-Ring	Viton	V0-014-70H
13	1	Backup	Teflon	TB-014-000
14	1	Hex Plug	316 St. Stl.	80-004-000
15*	1	O-Ring	Viton	V0-013-70H
16*	1	O-Ring	Viton	V0-129-70H
17*	1	O-Ring	Viton	V0-006-70H
18	1	Spring	Inconel	80-006-000
19	1	Cap	316 St. Stl.	80-010-000
20	1	Repair Kit	* Items	80-015-000

DIMENSION INCH (MM)

"A"	6.85 (174)
"B"	2.5 (63.5)
"C"	1.75 (44.5)
"D"	1/4" FNPT
"E"	1/4" FNPT
WEIGHT	4.0 lbs. (1.81 kg)

Pilot Section Specifications P.s.i. (BAR)	
Max. Operating Pressure	200 (13.8)
Burst Pressure	500 (34.5)
Fluid	Air/ Hydraulics
Ambient Temperature Range	-20° to 160° F -29° to 70° C

Hydraulic Section Specifications P.s.i. (BAR)	
Max. Operating Pressure	10,000 (690)
Burst Pressure	12000 (828)
Cv Factor	.25
Temperature Range	-20° to 160° F -29° to 70° C

ORDERING CODE:

8001 X 20000

Base Model Number

Standard Corrosive Service - (-)

N.A.C.E. Option - N

Arctic Service - A