



1209 DISTRIBUTORS ROW ■ HARAHAN, LA 70123 U.S.A.  
TELEPHONE: (504)340-0055 ■ FAX: (504)340-0056

**GENERAL DESCRIPTION:**

The Ruelco Fuse Plug is a heat sensitive device designed to vent control pressure. The sensing temperature of the fusible material is clearly marked on each fuse plug to assure proper identification.

The Ruelco fuse plugs are available in 316 stainless steel with various sizes.

HIGH PRESSURE  
FUSE PLUG

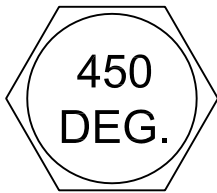

TEMPERATURE  
DESIGNATION ETCHED  
ON TOP

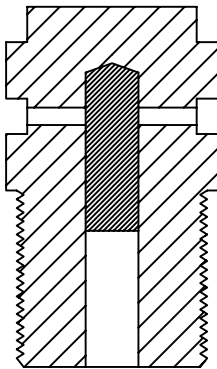

**FEATURES:**

- \* 316 Stainless steel construction (models to N.A.C.E. MRO175 available).
- \* Leak free seal.
- \* Small compact design.  
Max. W.P. 6,000 psi

**OPTIONS:**

- \* 1/4", 3/8" MNPT sizes.
- \* 450° F sensing temperature.

TEMPERATURE SENSOR

MODEL 2103-25450

ORDERING CODE: 2103 - XX 450

1/4" MNPT --- 25		└──┬──┘
3/8" MNPT --- 37		

MODEL 2103